

NO-SKIVE

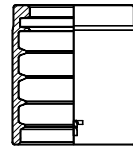

BXC

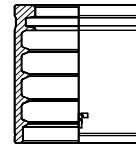

BXT1

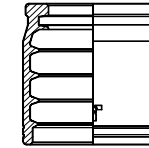

BXT2

NO-SKIVE

RUBBER HOSES STEEL WIRE BRAIDED - TUBI GOMMA TRECCIATI ACCIAIO

Hose Size			ISO 11237 1SC			ISO 11237 2SC						ISO 1436 1SN SAE100 R1AT						ISO 1436 2SN SAE100 R2AT			Collapse control mandrel Spina controllo collasso
			Ferrule Boccola	Skiving length Lungh. di pelatura	Ø Swage (Ref.) Ø Press. (Rif.)	Ferrule Boccola	Skiving length Lungh. di pelatura	Ø Swage (Ref.) Ø Press. (Rif.)	Ferrule Boccola	Skiving length Lungh. di pelatura	Ø Swage (Ref.) Ø Press. (Rif.)	Ferrule Boccola	Skiving length Lungh. di pelatura	Ø Swage (Ref.) Ø Press. (Rif.)	Ferrule Boccola	Skiving length Lungh. di pelatura	Ø Swage (Ref.) Ø Press. (Rif.)	Ferrule Boccola	Skiving length Lungh. di pelatura	Ø Swage (Ref.) Ø Press. (Rif.)	
DN	Inch	Dash	Part.N.	mm	mm	Part.N.	mm	mm	Part.N.	mm	mm	Part.N.	mm	mm	Part.N.	mm	mm	Part.N.	mm	mm	Part.N.
5	3/16"	-03										BXT103	no skive	15,2				BXT203	no skive	15,9	SCP03
6,3	1/4"	-04	BXC04	no-skive	15	BXT104	no-skive	16,1	BXT204	no-skive	16,7	BXT104	no-skive	16,1	BXT204	no-skive	16,7	BXT204	no-skive	18,1	SCP04
8	5/16"	-05	BXC05	no-skive	16,3	BXT105	no-skive	17,9	BXT205	no-skive	18,5	BXT105	no-skive	17,9	BXT205	no-skive	18,5	BXT205	no-skive	19,9	SCP05
10	3/8"	-06	BXC06	no-skive	18,7	BXT106	no-skive	20,1	BXT206	no-skive	20,2	BXT106	no-skive	20,2	BXT206	no-skive	20,3	BXT206	no-skive	21,7	SCP06
12,5	1/2"	-08	BXC08	no-skive	22,2	BXT108	no-skive	23,7	BXT208	no-skive	24	BXT108	no-skive	23,7	BXT208	no-skive	24	BXT208	no-skive	25,4	SCP08
16	5/8"	-10	BXC10	no-skive	25,3	BXT110	no-skive	27,3	BXT210	no-skive	27,8	BXT110	no-skive	27,3	BXT210	no-skive	27,8	BXT210	no-skive	29,3	SCP10
19	3/4"	-12	BXC12	no-skive	29	BXT112	no-skive	31,4	BXT212	no-skive	31,9	BXT112	no-skive	31,3	BXT212	no-skive	31,8	BXT212	no-skive	33,3	SCP12
25	1"	-16	BXC16	no-skive	37	BXT116	no-skive	39,7				BXT116	no-skive	39,6				BXT216	no-skive	42	SCP16
31,5	1 1/4"	-20										BXT120	no-skive	47,9				BXT220	no-skive	53,5	SCP20
38	1 1/2"	-24										BXT124	no-skive	54,7				BXT224	no-skive	59,8	SCP24
51	2"	-32										BXT132	no-skive	68,3				BXT232	no-skive	72,3	SCP32

NO-SKIVE				NO-SKIVE
	BXC	BXT1	BXT2	

RUBBER HOSES STEEL WIRE BRAIDED - TUBI GOMMA TRECCIATI ACCIAIO

Hose Size			SAE100 R16			ISO 11237 R16S SAE100 R16S			ISO 11237 R17 SAE100 R17			ISO 11237 R19 SAE100 R19						Collapse control mandrel Spina controllo collasso			
			Ferrule Boccola	Skiving length Lungh. di pelatura	Ø Swage (Ref.) Ø Press. (Rif.)	Ferrule Boccola	Skiving length Lungh. di pelatura	Ø Swage (Ref.) Ø Press. (Rif.)	Ferrule Boccola	Skiving length Lungh. di pelatura	Ø Swage (Ref.) Ø Press. (Rif.)	Ferrule Boccola	Skiving length Lungh. di pelatura	Ø Swage (Ref.) Ø Press. (Rif.)	Ferrule Boccola	Skiving length Lungh. di pelatura	Ø Swage (Ref.) Ø Press. (Rif.)		Ferrule Boccola	Skiving length Lungh. di pelatura	Ø Swage (Ref.) Ø Press. (Rif.)
DN	Inch	Dash	Part.N.	mm	mm	Part.N.	mm	mm	Part.N.	mm	mm	Part.N.	mm	mm	Part.N.	mm	mm	Part.N.	mm	mm	Part.N.
																					SCP03
6,3	1/4"	-04	BXT104	no-skive		BXT104	no-skive		BXC04	no-skive		BXT103	no-skive								SCP04
8	5/16"	-05	BXT105	no-skive		BXT105	no-skive		BXC05	no-skive		BXT104	no-skive								SCP05
10	3/8"	-06	BXT106	no-skive		BXT106	no-skive		BXC06	no-skive		BXT105	no-skive								SCP06
12,5	1/2"	-08	BXT108	no-skive		BXT108	no-skive		BXT108	no-skive		BXT106	no-skive								SCP08
16	5/8"	-10	BXT110	no-skive		BXT110	no-skive		BXT210	no-skive		BXT208	no-skive								SCP10
19	3/4"	-12	BXT112	no-skive		BXT112	no-skive		BXT212	no-skive											SCP12
25	1"	-16	BXT116	no-skive		BXT116	no-skive		BXT216	no-skive											SCP16
31,5	1 1/4"	-20	BXT120	no-skive		BXT120	no-skive														SCP20

For R16 - R17 - R19 and other compact braided hoses applications, contact TIEFFE.

Per applicazioni R16 - R17 - R19 ed altri tubi trecciati compatti, contattare la TIEFFE.

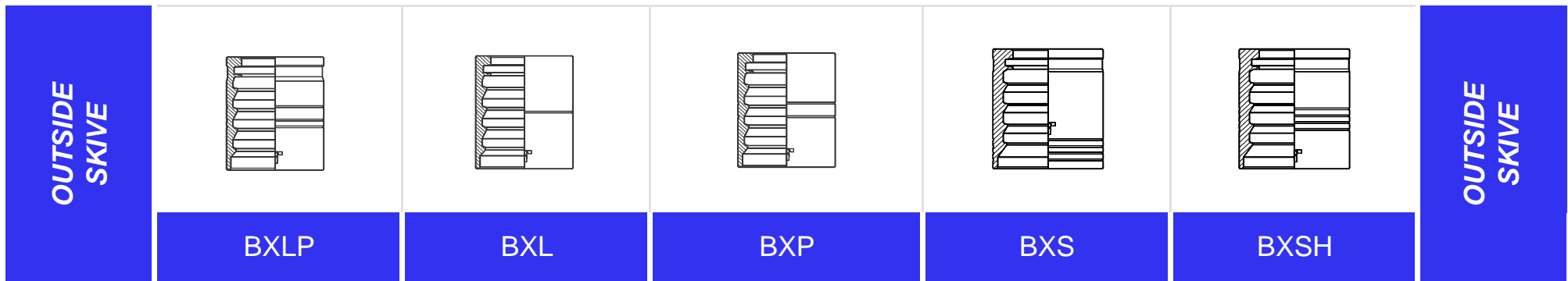

RUBBER HOSES STEEL WIRE BRAIDED - TUBI GOMMA TRECCIATI ACCIAIO

Hose Size			ISO 1436 1SN SAE100 R1AT			ISO 1436 2SN SAE100 R2AT			ISO 11237 2SC			ISO 1436 1SN SAE100 R1AT			ISO 1436 2SN SAE100 R2AT			ISO 1436 2ST SAE100 R2A			Collapse control mandrel Spina controllo collasso	
			Ferrule Boccola	Skiving length Lungh. di pelatura	Ø Swage (Ref.) Ø Press. (Rif.)	Ferrule Boccola	Skiving length Lungh. di pelatura	Ø Swage (Ref.) Ø Press. (Rif.)	Ferrule Boccola	Skiving length Lungh. di pelatura	Ø Swage (Ref.) Ø Press. (Rif.)	Ferrule Boccola	Skiving length Lungh. di pelatura	Ø Swage (Ref.) Ø Press. (Rif.)	Ferrule Boccola	Skiving length Lungh. di pelatura	Ø Swage (Ref.) Ø Press. (Rif.)	Ferrule Boccola	Skiving length Lungh. di pelatura	Ø Swage (Ref.) Ø Press. (Rif.)		
DN	Inch	Dash	Part.N.	mm	mm	Part.N.	mm	mm	Part.N.	mm	mm	Part.N.	mm	mm	Part.N.	mm	mm	Part.N.	mm	mm	Part.N.	
5	3/16"	-03	BXLP03	18	13,0	BXLP03	18	14,4													SCP03	
6,3	1/4"	-04	BXLP04	20	15	BXLP04	20	16,4	BXLP04	20	15,0											SCP04
8	5/16"	-05	BXLP05	20	16,5	BXLP05	20	17,9	BXLP05	20	16,5											SCP05
10	3/8"	-06	BXLP06	23	18,5	BXLP06	23	20	BXLP06	23	18,4							BXS06	22	22,4		SCP06
12,5	1/2"	-08	BXLP08	25	22,3	BXLP08	25	23,7	BXLP08	25	22,3							BXS08	24	25,6		SCP08
16	5/8"	-10	BXLP10	27	26,7	BXLP10	27	28,2	BXLP10	27	26,7							BXS10	27	29,2		SCP10
19	3/4"	-12	BXLP12	31	30,8	BXLP12	31	32,3	BXLP12	31	30,7							BXS12	30	32,7		SCP12
25	1"	-16	BXLP16	34	38,5	BXLP16	34	40	BXLP16	34	38,2							BXS16	38	41,5		SCP16
31,5	1 1/4"	-20										BXL20	39	45,2	BXP20	40	49,6	BXS20	45	50,6		SCP20
38	1 1/2"	-24										BXL24	43	52,7	BXP24	44	57,6	BXS24	50	59,2		SCP24
51	2"	-32										BXL32	58	65,2	BXP32	60	70,5	BXSH32	55	71		SCP32

NO SKIVE

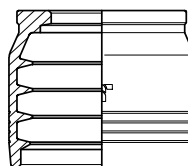

NO SKIVE

BXT4

RUBBER HOSES STEEL WIRE SPIRAL - TUBI GOMMA SPIRALATI ACCIAIO

Hose Size			ISO 3862 4SP			ISO 3862 4SH**			ISO 3862 R12 SAE100 R12									Collapse control mandrel Spina controllo collasso				
			Ferrule Boccola	Skiving length Lungh. di pelatura	Ø Swage (Ref.) Ø Press. (Rif.)	Ferrule Boccola	Skiving length Lungh. di pelatura	Ø Swage (Ref.) Ø Press. (Rif.)	Ferrule Boccola	Skiving length Lungh. di pelatura	Ø Swage (Ref.) Ø Press. (Rif.)	Ferrule Boccola	Skiving length Lungh. di pelatura	Ø Swage (Ref.) Ø Press. (Rif.)	Ferrule Boccola	Skiving length Lungh. di pelatura	Ø Swage (Ref.) Ø Press. (Rif.)		Part.N.			
DN	Inch	Dash	Part.N.	mm	mm	Part.N.	mm	mm	Part.N.	mm	mm	Part.N.	mm	mm	Part.N.	mm	mm	Part.N.	mm	mm	Part.N.	
10	3/8"	-06	BXT406	no-skive	24,3				BXT406	no-skive	23,3											SCP06
12,5	1/2"	-08	BXT408	no-skive	27,4				BXT408	no-skive	26,7											SCP08
16	5/8"	-10	BXT410	no-skive	31,4				BXT410	no-skive	30,7											SCP10
19	3/4"	-12	BXT412	no-skive	36	BXT412	no-skive	36,0	BXT412	no-skive	34,6											SCP12
25	1"	-16	BXT416	no-skive	42,5	BXT416	no-skive	41,6	BXT416	no-skive	41											SCP16

** The application of "CX" series hose fittings must be limited to the "ISO 3862 4SP" maximum working pressure.

** L'applicazione dei raccordi per tubo flessibile serie "CX" deve essere limitata alla massima pressione di esercizio del tubo "ISO 3862 4SP".

OUTSIDE
SKIVE

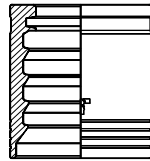

BXS

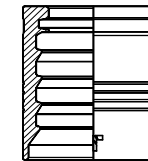

BXSH

OUTSIDE
SKIVE

RUBBER HOSES STEEL WIRE SPIRAL - TUBI GOMMA SPIRALATI ACCIAIO

Hose Size			ISO 3862 4SP			ISO 3862 4SH**			ISO 3862 R12 SAE100 R12									Collapse control mandrel Spina controllo collasso				
			Ferrule Boccola	Skiving length Lungh. di pelatura	Ø Swage (Ref.) Ø Press. (Rif.)	Ferrule Boccola	Skiving length Lungh. di pelatura	Ø Swage (Ref.) Ø Press. (Rif.)	Ferrule Boccola	Skiving length Lungh. di pelatura	Ø Swage (Ref.) Ø Press. (Rif.)	Ferrule Boccola	Skiving length Lungh. di pelatura	Ø Swage (Ref.) Ø Press. (Rif.)	Ferrule Boccola	Skiving length Lungh. di pelatura	Ø Swage (Ref.) Ø Press. (Rif.)		Ferrule Boccola	Skiving length Lungh. di pelatura	Ø Swage (Ref.) Ø Press. (Rif.)	
DN	Inch	Dash	Part.N.	mm	mm	Part.N.	mm	mm	Part.N.	mm	mm	Part.N.	mm	mm	Part.N.	mm	mm	Part.N.	mm	mm	Part.N.	
6,3	1/4"	-04	BXS04	18	19,0																	SCP04
10	3/8"	-06	BXS06	22	23				BXS06	22	22,7											SCP06
12,5	1/2"	-08	BXS08	24	26,7				BXS08	24	26,4											SCP08
16	5/8"	-10	BXS10	27	30,7				BXS10	27	30,6											SCP10
19	3/4"	-12	BXS12	30	34,4	BXS12	30	34,0	BXS12	30	33,2											SCP12
25	1"	-16	BXS16	38	42	BXS16	38	41,8	BXS16	38	41,4											SCP16
31,5	1 1/4"	-20	BXS20	45	51	BXSH20	45	48,8	BXS20	45	49,9											SCP20
38	1 1/2"	-24	BXS24	50	60	BXSH24	50	57	BXS24	50	58,8											SCP24
51	2"	-32	BXS32	55	74	BXSH32	55	70,7	BXSH32	55	71,1											SCP32

** The application of "CX" series hose fittings must be limited to the "ISO 3862 4SP" maximum working pressure.

** L'applicazione dei raccordi per tubo flessibile serie "CX" deve essere limitata alla massima pressione di esercizio del tubo "ISO 3862 4SP".

NO-SKIVE					NO-SKIVE
	BX7	BX8	BP3	BXP	

RUBBER HOSES TEXTILE BRAIDED - TUBI GOMMA TRECCIATI TESSILI

Hose Size			ISO 4079 1TE			ISO 4079 2TE			ISO 4079 3TE			ISO 4079 R6 SAE100 R6			ISO 4079 R3 SAE100 R3					
			Ferrule Boccola	Skiving length Lungh. di pelatura	Ø Swage (Ref.) Ø Press. (Rif.)	Ferrule Boccola	Skiving length Lungh. di pelatura	Ø Swage (Ref.) Ø Press. (Rif.)	Ferrule Boccola	Skiving length Lungh. di pelatura	Ø Swage (Ref.) Ø Press. (Rif.)	Ferrule Boccola	Skiving length Lungh. di pelatura	Ø Swage (Ref.) Ø Press. (Rif.)	Ferrule Boccola	Skiving length Lungh. di pelatura	Ø Swage (Ref.) Ø Press. (Rif.)	Ferrule Boccola	Skiving length Lungh. di pelatura	Ø Swage (Ref.) Ø Press. (Rif.)
DN	Inch	Dash	Part.N.	mm	mm	Part.N.	mm	mm	Part.N.	mm	mm	Part.N.	mm	mm	Part.N.	mm	mm	Part.N.	mm	mm
5	3/16"	-03	BX703	no-skive																
6,3	1/4"	-04	BX704	no-skive		BP304	no-skive		BP304	no-skive		BX704	no-skive		BP304	no-skive				
8	5/16"	-05	BX705	no-skive		BX705	no-skive		BP305	no-skive		BX705	no-skive		BP305	no-skive				
10	3/8"	-06	BX706	no-skive		BX706	no-skive		BP306	no-skive		BX706	no-skive		BP306	no-skive				
12,5	1/2"	-08	BX708	no-skive		BX708	no-skive		BP308	no-skive		BX708	no-skive		BP308	no-skive				
16	5/8"	-10	BX710	no-skive		BX710	no-skive		BP310	no-skive		BX710	no-skive		BP310	no-skive				
19	3/4"	-12				BX712	no-skive		BP312	no-skive		BX712	no-skive		BP312	no-skive				
25	1"	-16				BX816	no-skive		BP316	no-skive					BP316	no-skive				
31,5	1 1/4"	-20							BP320	no-skive					BP320	no-skive				
38	1 1/2"	-24							BXP24	no-skive										
51	2"	-32							BXP32	no-skive										

NO-SKIVE

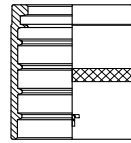

BX7

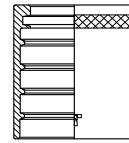

BX8

NO-SKIVE

THERMOPLASTIC HOSES - TUBI TERMOPLASTICI

Hose Size			ISO 3949 R7 SAE100 R7			ISO 3949 R8 SAE100 R8			ISO 3949 R18 SAE100 R18									Collapse control mandrel Spina controllo collasso				
			Ferrule Boccola	Skiving length Lungh. di pelatura	Ø Swage (Ref.) Ø Press. (Rif.)	Ferrule Boccola	Skiving length Lungh. di pelatura	Ø Swage (Ref.) Ø Press. (Rif.)	Ferrule Boccola	Skiving length Lungh. di pelatura	Ø Swage (Ref.) Ø Press. (Rif.)	Ferrule Boccola	Skiving length Lungh. di pelatura	Ø Swage (Ref.) Ø Press. (Rif.)	Ferrule Boccola	Skiving length Lungh. di pelatura	Ø Swage (Ref.) Ø Press. (Rif.)		Ferrule Boccola	Skiving length Lungh. di pelatura	Ø Swage (Ref.) Ø Press. (Rif.)	
DN	Inch	Dash	Part.N.	mm	mm	Part.N.	mm	mm	Part.N.	mm	mm	Part.N.	mm	mm	Part.N.	mm	mm	Part.N.	mm	mm	Part.N.	
5	3/16"	-03	BX703	no-skive		BX703	no-skive			no-skive												SCP03
6,3	1/4"	-04	BX704	no-skive		BX704	no-skive			no-skive												SCP04
8	5/16"	-05	BX705	no-skive		BX705	no-skive			no-skive												SCP05
10	3/8"	-06	BX706	no-skive		BX706	no-skive			no-skive												SCP06
12,5	1/2"	-08	BX708	no-skive		BX708	no-skive			no-skive												SCP08
16	5/8"	-10	BX710	no-skive		BX710	no-skive			no-skive												SCP10
19	3/4"	-12	BX712	no-skive		BX712	no-skive			no-skive												SCP12
25	1"	-16	BX716	no-skive		BX816	no-skive			no-skive												SCP16
31,5	1 1/4"	-20																				SCP20
38	1 1/2"	-24																				
51	2"	-32																				